

# MäePark

HillPark



SUSTAINABLE CITIES IN THE NORDIC BALTIC REGION

**Team 2 :** Kingsley Koranteng, Adela Briansó Junquera, Regita Zeila, Mathew Page



# Focus:

Create a model that would allow:

- Removing cars from courtyard edges and green areas
- Increase multifunctional use of courtyards

...how?



# Strategy

**1. Courtyard multifunctionality**

**2. Providing alternative parking spaces**

**3. Prioritising different mobility options**

# Current Situation

- Cars are parking on the courtyard edges
- No functional use of the courtyards
- Dangerous pathways, not suitable for families / kids
- Car-centric approach
- Season-specific courtyard uses



# 1. Creating **multifunctional** courtyards

By building a hill in the courtyard that would host parking spaces underneath:

- Enabling to park cars close to residence
- A space for many other (seasonal-dependent) uses
- A **model** for different courtyards - different possibilities



## 1. Creating **multifunctional** courtyards

Eliminating parking on edges, making the courtyard more attractive

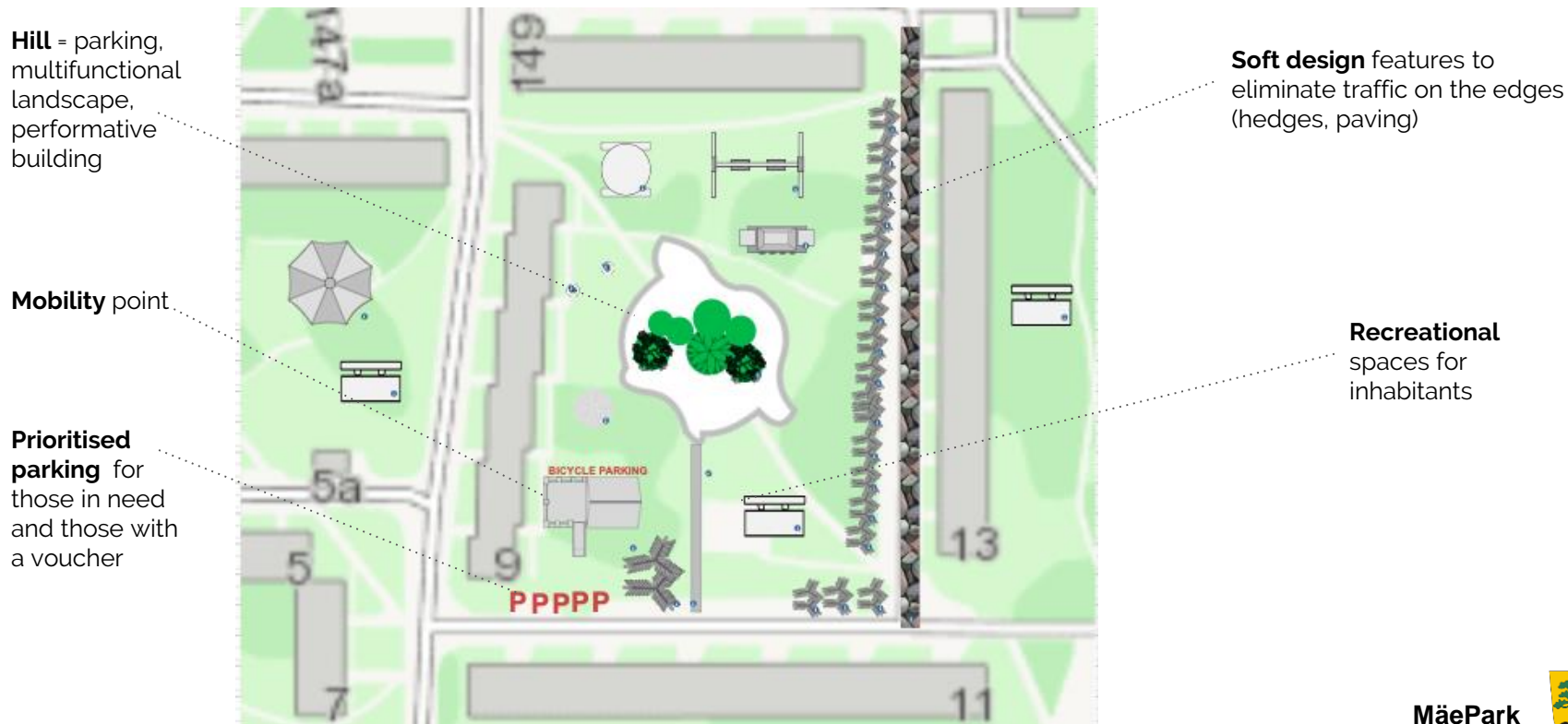

# 1. Creating **multifunctional** courtyards

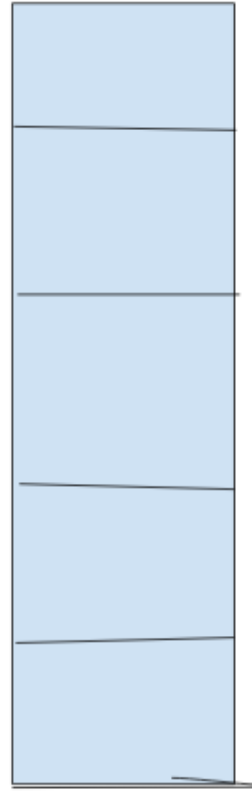
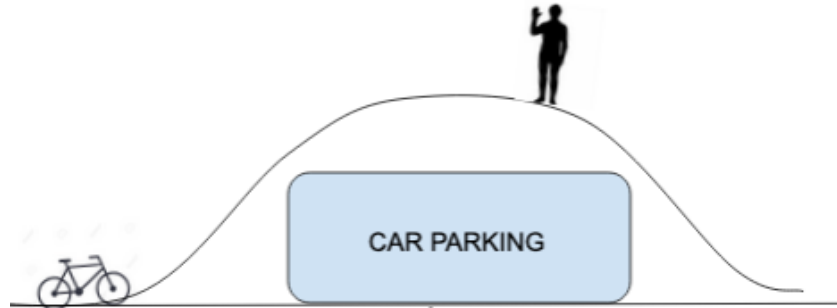
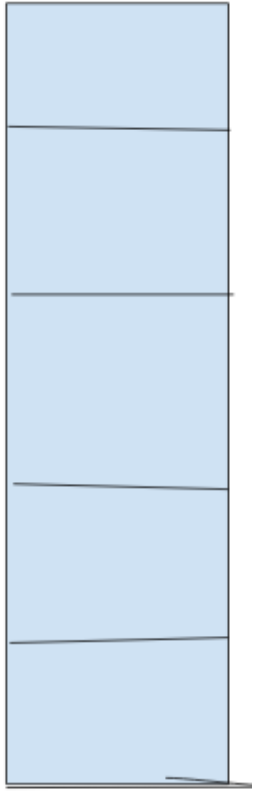



# 1. Creating **multifunctional** courtyards

Summer use



<https://www.pinterest.com/pin/142637513176741772/>



<https://insideguide.co.za/cape-town/markets/>



# 1. Creating **multifunctional** courtyards

Winter use



[https://www.123rf.com/photo\\_51352924\\_vintage-ladle-with-hot-mulled-wine-on-a-fire-winter-outdoor-selective-focus-.html](https://www.123rf.com/photo_51352924_vintage-ladle-with-hot-mulled-wine-on-a-fire-winter-outdoor-selective-focus-.html)

# 1. Creating **multifunctional** courtyards

## Why?

- Increased wellbeing
- More inclusive use of space (ages groups and uses)
- safety



# 1. Creating **multifunctional** courtyards

## How?

- **With excavation (\$\$\$):** multi-use performative building (workshops and community events)



# 1. Creating **multifunctional** courtyards

## How?

- **Reduced cost option:**  
maximise car parking underneath the hill  
to reduce stress at street level

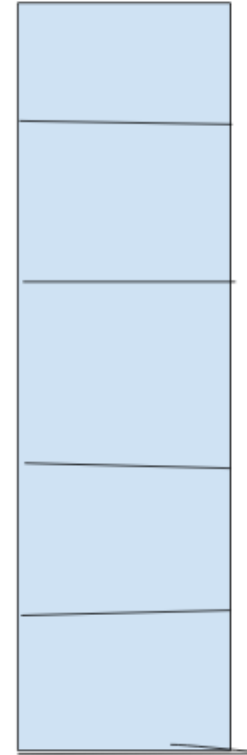
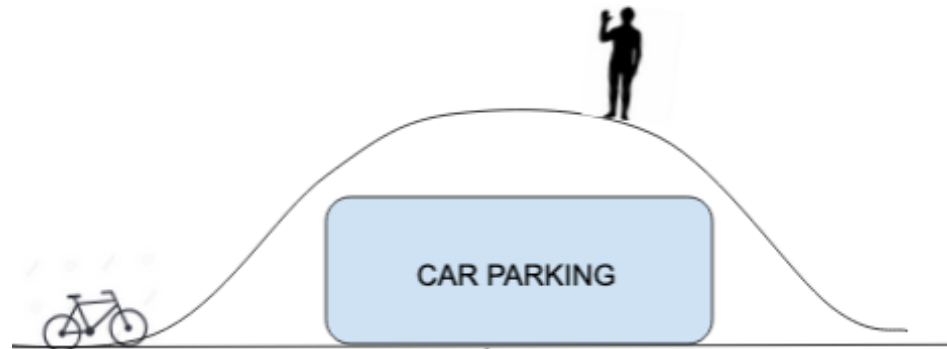
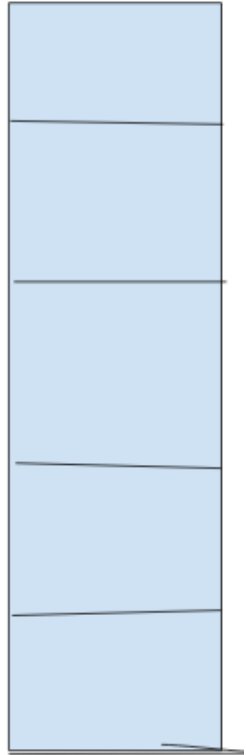

# 1. Creating **multifunctional** courtyards

## Who?

- Community groups invited to develop and make use of the space (bottom up decision making)
- All age groups: inclusive approach
- Youth associations
- NGOs, workshop facilitators, artists



Skamlingsbanken Visitor Center by CEBRA

<https://inhabitat.com/new-green-roofed-visitor-center-in-denmark-to-be-nestled-under-a-softly-curved-hill/skamlingsbanken-visitor-center-by-cebra-lead/>





Space available



## 2. Providing **alternative** parking spaces

### What?

- **Providing** spaces for cars away from courtyards
- **Encouraging** moving of vehicles which usually remain stationary.



## 2. Providing **alternative** parking spaces

### Why?

- Reduce traffic in residential areas
- Health and safety concerns
- Improve aesthetic
- Encourage more recreational activities in courtyards



## 2. Providing **alternative** parking spaces

### How?

- **Providing** new parking at exterior
- Introduce permits
- **Encourage** stationery vehicles to move outside of courtyard with Tiered Permit Structure
  - Non-punitive
  - Residents benefit - non-residents prevented from using their parking.
- Encourage use of other mobility options between parking spots and homes (part 3. of this strategy)

### Indicative Permit Pricing Structure:

Zone A (Near Residence)	Zone B (External)
20 euro / month	10 euro/month



<https://www.myparkingsign.com>

## 2. Providing **alternative** parking spaces

### Who?

- District Government
- Public/Private Partnership
- Vehicle Owners



## 2. Providing **alternative** parking spaces

Using existing infrastructure - when possible





### 3. Prioritising different mobility options

#### What?

- bicycles (private and shared scheme), sheds (seasonality) (ensure seasonality feasibility)
- Car sharing schemes



<https://www.externalworksindex.co.uk/entry/134736/Harrowden-Turf/Wildflower-green-roof-for-cycle-shed/>



### 3. Prioritising different mobility options

#### Why?

- Connectivity
- Wellbeing
- Sustainability

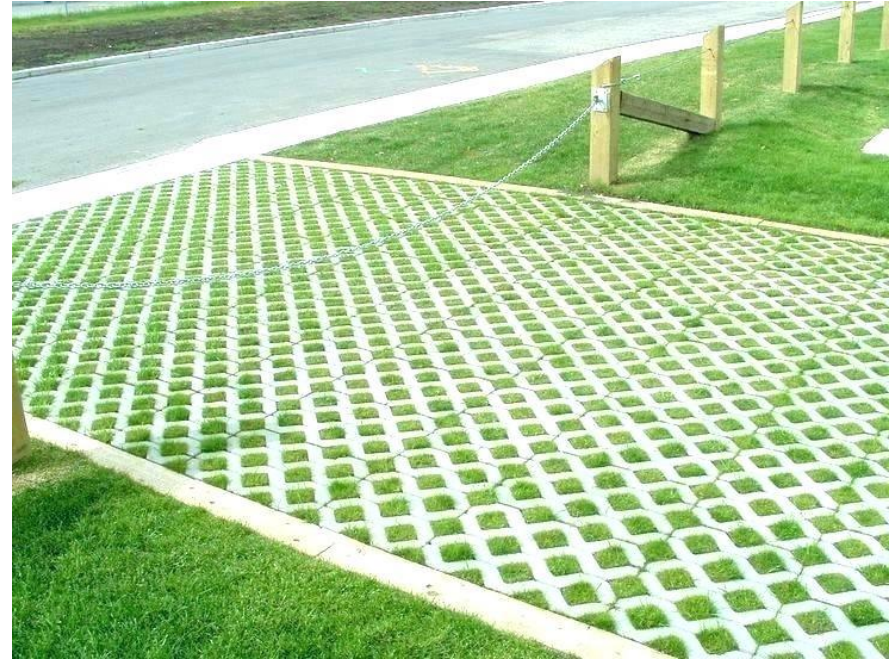

<https://www.gettyimages.ie/detail/photo/outdoor-flooring-with-grass-and-paving-stones-royalty-free-image/126254974>



### 3. Prioritising different mobility options

#### How?

- zoning, signage (limited speed etc.) -  
>limiting car use of edges (prioritise use, specific parking spaces (different social groups - people with disabilities etc.)
- benefits to users (friendly competitions, vouchers to use (local produce etc.)
- physical barriers (**hedges**) etc. (these can be platforms for community engagement)
- possibility to book parking close to buildings if needed



<https://www.ecolandscaping.org/02/designing-ecological-landscapes/native-plants/native-shrubs-for-the-increasingly-challenging-landscape-environment/>

### 3. Prioritising different mobility options

#### Who?

- local government
- start ups (bike)
- local producers
- landlords' association(s)
- Residents, activists



[https://www.inyourpocket.com/vilnius/citybee\\_145883v](https://www.inyourpocket.com/vilnius/citybee_145883v)

# Summary

## 1. Courtyard multifunctionality

- **Hill** = parking, multifunctional landscape, performative building, **Recreational** spaces for inhabitants, **Mobility** point, **Design** features to eliminate traffic on the edges (hedges, pathing), **Prioritised parking** for those in need and one with a voucher

## 1. Providing alternative parking spaces

- **Providing, Encourage** use of available spaces **elsewhere**, non-punitive, **Encourage use of other mobility options**

## 1. Prioritising different mobility options

- **Zoning**, signage, **benefits to users**, physical barriers, **price differentiation**

# MäePark



*Soft Edges*



*Seasonality / multifunctionality*



*Alternative mobility*



# The process of implementation

Community involvement

Actively prioritising alternative connectivity

Motivational program: encouraging use of alternative parking outside the courtyards

Building / maintaining the hill, multifunctional and evolving courtyards

Local governance program in place (restrictions, zoning)

Efficient and closeby alternatives

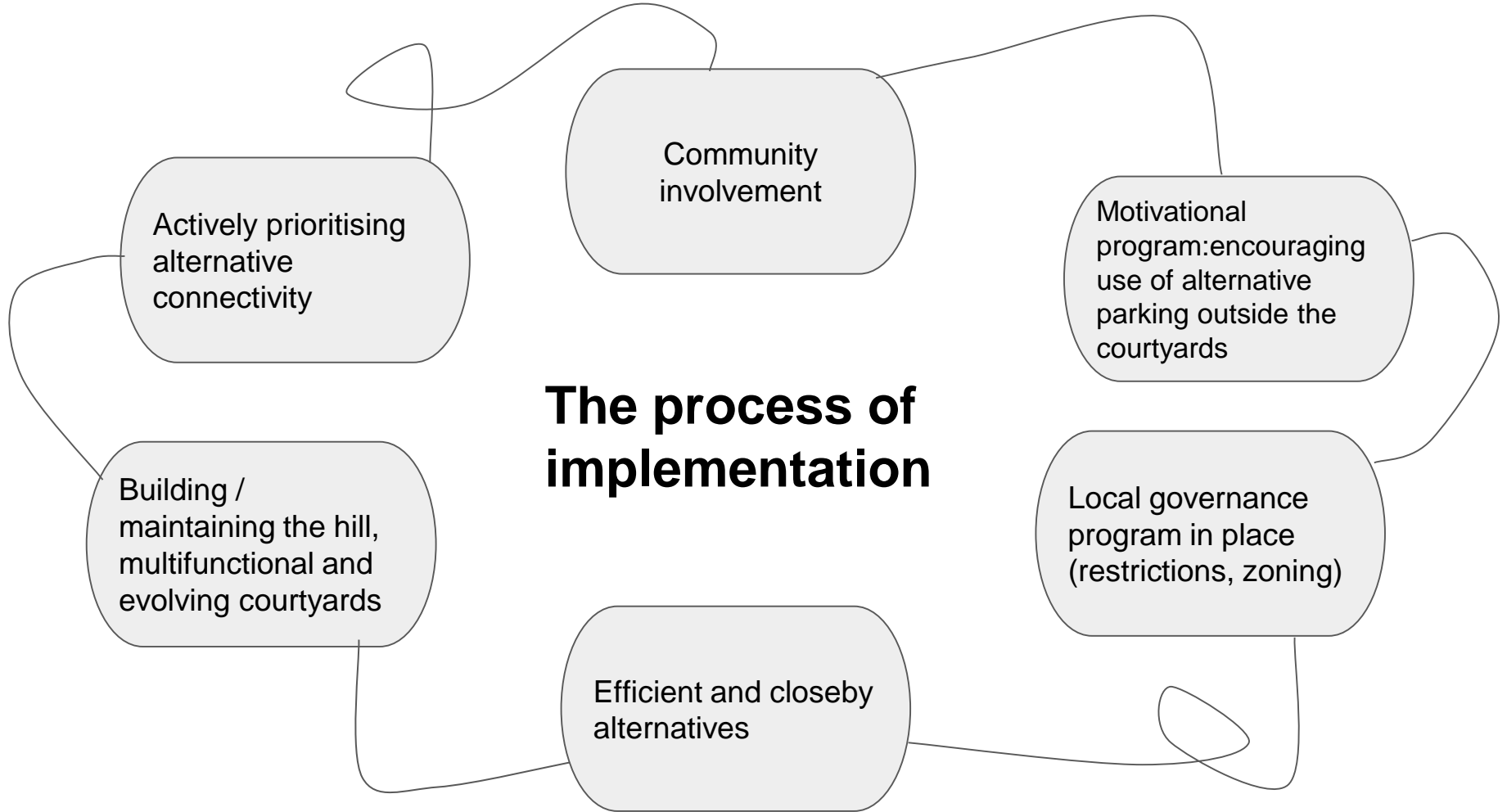



Kingsley Koranteng

Geoinformatics for Urbanized  
Society

University of Tartu

Regita Zeila

Geography

University of Latvia

Adela Briansó Junquera

Global Health

University of Copenhagen

Mathew Page

Urban Studies and Planning

University of Helsinki





A thin, light blue line forms a smooth, symmetrical bell curve that arches over the text. The curve starts low on the left, rises to a peak centered above the text, and then descends to a low point on the right.

Thank you!